

STATES OF JERSEY



LAND TRANSACTIONS UNDER STANDING ORDER 168(3) –

- (a) FIELDS 800, 800A AND 801, REAR OF JCG PREPARATORY SCHOOL, CLAREMONT ROAD, ST. SAVIOUR: LEASE;
 - (b) BEAU SEJOUR, MONT MILLAIS, ST. HELIER, JE2 4RA: LEASE.
-

Presented to the States on 12th March 2007
by the Minister for Treasury and Resources

STATES GREFFE

REPORT

Decision(s): Under Standing Order 168(3) the Minister for Treasury and Resources hereby notifies the States that he has accepted the recommendation of the Property Holdings Department to agree to the following –

(a) Land transaction –

For the Public to enter into a 4-year lease with Jersey Royal (Potato Marketing) Limited of Fields 800, 800A and 801, St. Saviour for a rental of £420.00 per annum from 24th December 2006.

The Minister hereby authorises Property Holdings to pass any contract which is required to be passed on behalf of the public.

After the expiry of 15 days following presentation to the States the transaction may be concluded.

(Drawing attached at Appendix.)

Further information on this decision can be found on www.gov.je under Ministerial Decisions/Treasury and Resources/Property Holdings (reference MD-PH-2007-0014).

(b) Land transaction –

(The Minister rescinded decision reference MD-PH-2007-0012. ^[1])

For the Public of the Island to enter into an agreement with Mr. Stuart Edward McInnes in relation to the lease of a three-bedroom property known as Beau Sejour, Mont Millais, St. Helier, JE2 4RA.

The lease shall be for a period of 1 year, with effect from 1st April 2007, upon tenants' internal repairing terms.

The rental shall be £17,760.00 per annum.

The Minister hereby authorises Property Holdings to pass any contract which is required to be passed on behalf of the public.

After the expiry of 15 days following presentation to the States the transaction may be concluded.

Further information on this decision can be found on www.gov.je under Ministerial Decisions/Treasury and Resources/Property Holdings (reference MD-PH-2007-0017).

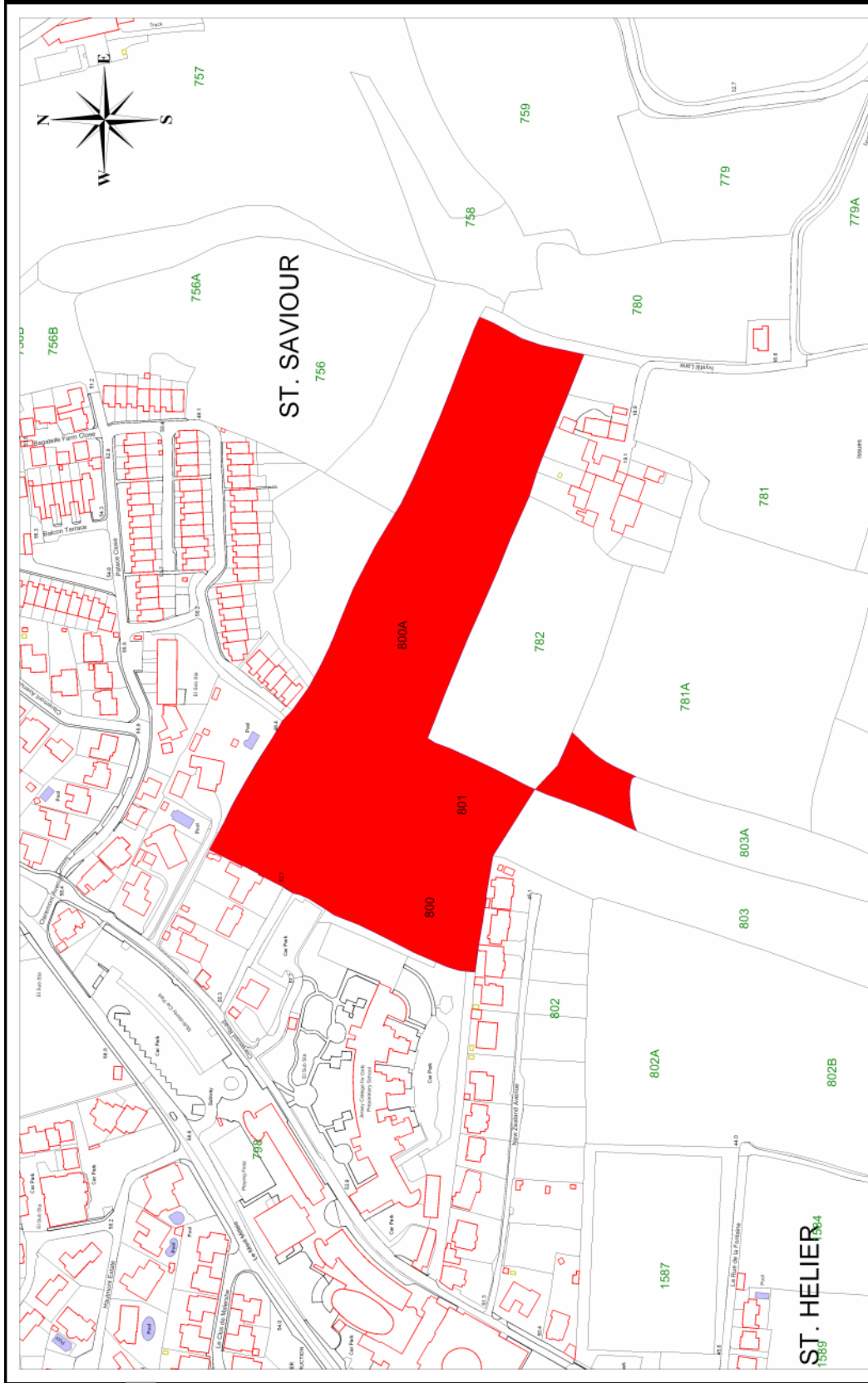

**Drawing No:
12/851/4**

Fields 800, 800 A and 801, Claremont Road, St Saviour
Boundary Information Supplied by the States of Jersey Planning Office, but no responsibility can be accepted for error.



**COPYRIGHT
STATES OF
JERSEY**

[1]

See R.17/2007.