

---

# STATES OF JERSEY



## LAND TRANSACTIONS UNDER STANDING ORDER 168(3) –

- (a) NEW NORTH QUAY WAREHOUSE, ST. HELIER – LEASE;
- (b) ST. AUBIN'S TUNNELS, MONT LES VAUX, ST. BRELADE –  
ST. BRELADE'S SMALL-BORE RIFLE CLUB – CANCELLATION OF  
LICENCE; PROPOSED 9 YEAR LEASE;
- (c) ST. SAVIOUR'S BOWLS CLUB, GRAINVILLE SPORTS GROUND,  
ST. SAVIOUR'S HILL, ST. SAVIOUR – LEASE;
- (d) ST. AUBIN'S TUNNELS, MONT LES VAUX, ST. BRELADE – JERSEY  
BOBSLEIGH CLUB – PROPOSED 9 YEAR LEASE;
- (e) FIELD 444A, LA RUE DU MOULIN, ST. MARTIN – PROPOSED SALE  
OF PART OF FIELD.

---

Presented to the States on 16th September 2014  
by the Minister for Treasury and Resources

---

STATES GREFFE

## REPORT

**Decision(s):** Under Standing Order 168(3) the Minister for Treasury and Resources hereby notifies the States that he has accepted the recommendation of the Property Holdings Department to agree to the following –

**(a) Land transaction –**

- (1) To lease out **N02 New North Quay Warehouse, St. Helier**, for a term of 9 years with effect from 1st January 2015 (or such other date to be agreed between the parties).
- (2) To confirm the above decision after giving the States 15 working days' notice of the transaction, and to cause the transaction to be completed.

After the expiry of 15 days following presentation to the States the transaction may be concluded.

*(Photograph attached at Appendix 1.)*

*Further information on this decision can be found on [www.gov.je](http://www.gov.je) under Ministerial Decisions/Treasury and Resources/Property Holdings (reference MD-PH-2014-0151).*

**(b) Land transaction –**

- (1) To let, for a term of 9 years, the premises at St. Aubin's Tunnels presently occupied under licence by the St. Brelade's Small-bore Rifle Club, in line with the terms set out in the accompanying report.
- (2) To confirm the above decision after giving the States 15 working days' notice of the transaction, and to cause the transaction to be completed.

After the expiry of 15 days following presentation to the States the transaction may be concluded.

*(Drawing attached at Appendix 2.)*

*Further information on this decision can be found on [www.gov.je](http://www.gov.je) under Ministerial Decisions/Treasury and Resources/Property Holdings (reference MD-PH-2014-0166).*

**(c) Land transaction –**

- (1) To grant a new 9 year lease to the existing tenant, under the terms and conditions set out in the accompanying report.
- (2) To confirm the above decision after giving the States 15 working days' notice of the transaction, and to cause the transaction to be completed.

After the expiry of 15 days following presentation to the States the transaction may be concluded.

*(Drawing attached at Appendix 3.)*

*Further information on this decision can be found on [www.gov.je](http://www.gov.je) under Ministerial Decisions/Treasury and Resources/Property Holdings (reference MD-PH-2014-0167).*

**(d) Land transaction –**

- (1) To let, to the Jersey Bobsleigh Club, for a term of 9 years, a unit at St. Aubin's Tunnels, in line with the terms set out in the accompanying report.
- (2) To confirm the above decision after giving the States 15 working days' notice of the transaction, and to cause the transaction to be completed.

After the expiry of 15 days following presentation to the States the transaction may be concluded.

*(Drawing attached at Appendix 2.)*

*Further information on this decision can be found on [www.gov.je](http://www.gov.je) under Ministerial Decisions/Treasury and Resources/Property Holdings (reference MD-PH-2014-0169).*

**(e) Land transaction –**

- (1) To sell part of Field 444A, La Rue du Moulin, St. Martin, measuring approximately 1,873 square feet, to the owner of 1 La Grande Maison Cottages, for an agreed consideration and on other terms as set out in the accompanying report.
- (2) To confirm the above decision after giving the States 15 working days' notice of the transaction, and to cause the transaction to be completed.

After the expiry of 15 days following presentation to the States the transaction may be concluded.

*(Drawing attached at Appendix 4.)*

*Further information on this decision can be found on [www.gov.je](http://www.gov.je) under Ministerial Decisions/Treasury and Resources/Property Holdings (reference MD-PH-2014-0170).*

APPENDIX 1



APPENDIX 2

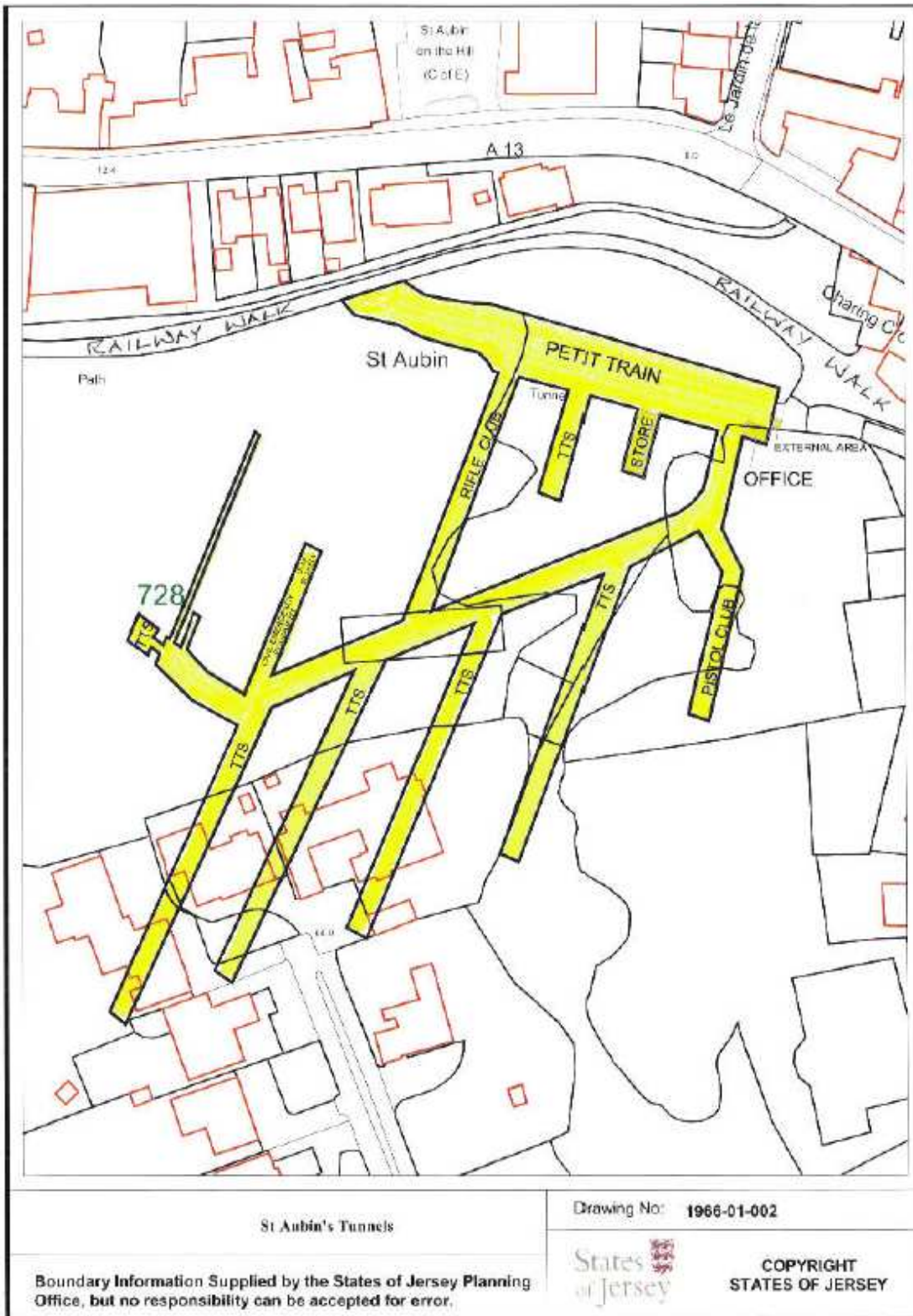



APPENDIX 3

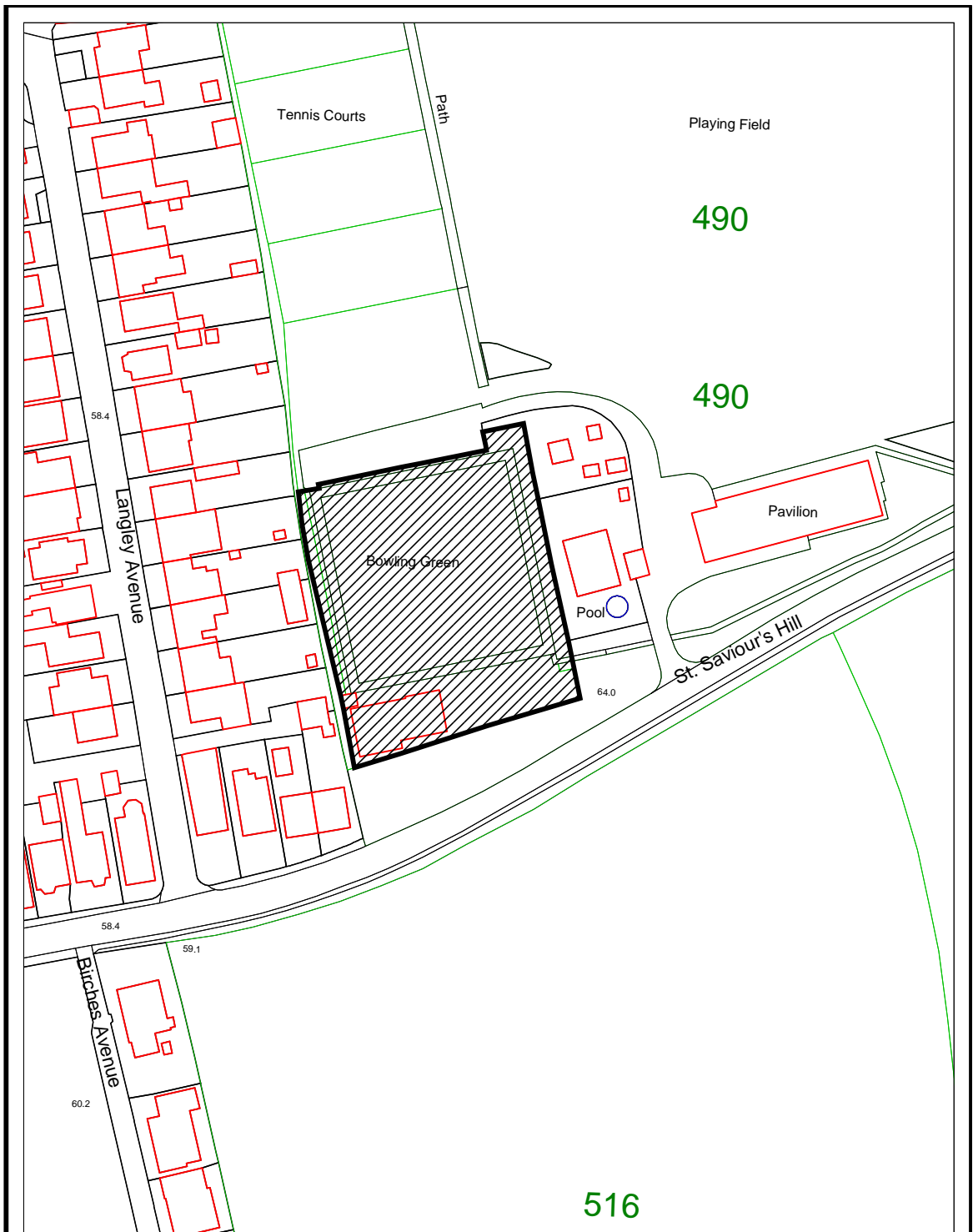

ST SAVIOUR'S BOWLS CLUB, GRAINVILLE SPORTS GROUND  
ST SAVIOUR'S HILL, ST SAVIOUR

Map for Identification Purposes Only.

Drawing No: 1297-01-003



COPYRIGHT  
STATES OF JERSEY

APPENDIX 4

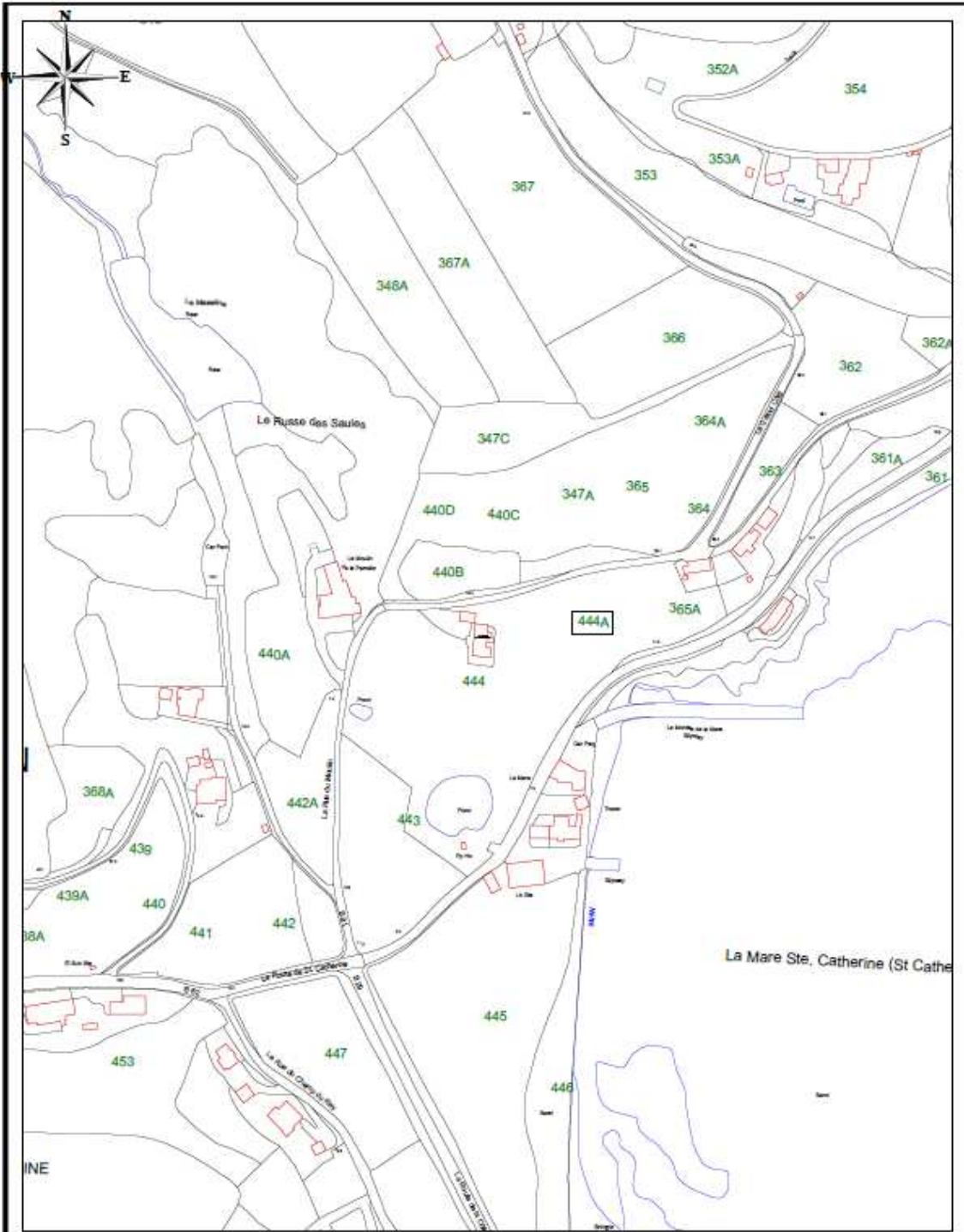

Field 444A, Rue du Moulin, St Martin

Drawing No: 0755 D1

Boundary Information Supplied by the States of Jersey Planning Office, but no responsibility can be accepted for error.



COPYRIGHT STATES OF JERSEY